

Overview

NRS 1 Series, General Electronics Racks for Servers, Networking, AV, Telecom & Lab application. Racks manufactured out of steel sheet punched, formed, welded and Powder coated with highest quality standards under stringent ISO 9001 | ISO 14001 | ISO 27001 | ISO 45001 Manufacturing & Quality management system to ensure highest quality product.

Standard for Racks configuration will be welded frame with vented top cover with fan mounting provision, Associated Front Glass or Perforated Metal Door with Lock & Key and Back Vented / Perforated Metal Door with Lock & Key and partially vented side panels, free standing on floor with 4 No. casters wheels with 2 No with brakes & 2 No. without brakes, optional levelers.

Available in 22RU~42RU Variants with 800 & 1000 Depth configurations and 800 Width configurations.





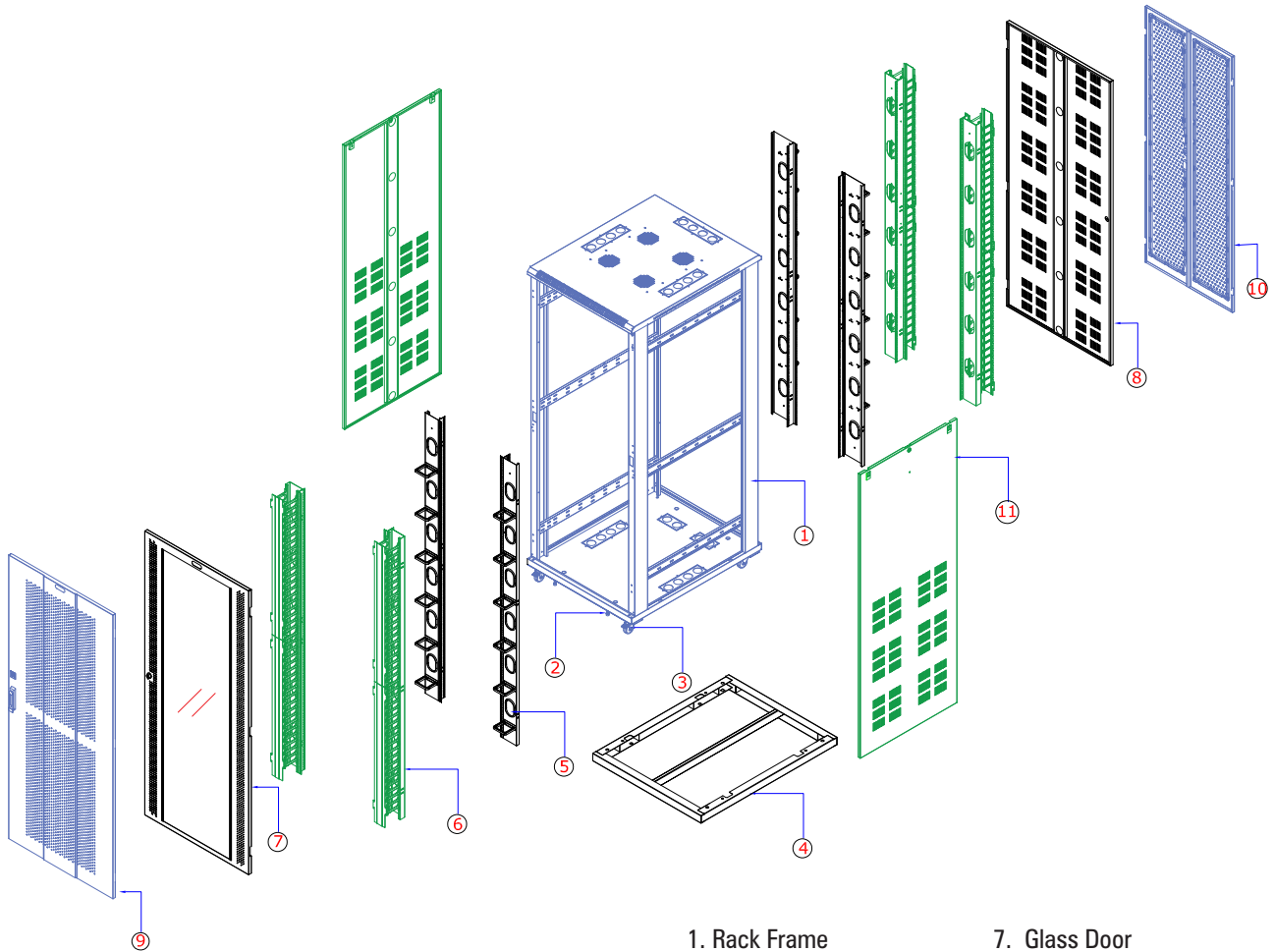

- | | |
|------------------------------------|--------------------------|
| 1. Rack Frame | 7. Glass Door |
| 2. Levellers | 8. Metal Door |
| 3. Castors | 9. Perforated Door Flat |
| 4. Plinth | 10. Perforated Door Dual |
| 5. 19" Adapter Kit/ loops | 11. Side Panel Vented |
| 6. 19" Adapter Kit/
closed Door | |

Features

- Conforms to DIN 41494 or Equivalent EIA / ISO / EN / CEA Standard
- Adjustable mounting depth
- 4 No Adjustable, 19" verticals with Punched 10 mm Square Hole and Universal 12.7mm-15.875mm-15.875mm alternating hole pattern offers greater mounting flexibility, maximizes usable mounting space
- Numbered U positions
- Universal 44.45MM Pitch Holes For DIN Standard Racks
- State-of-the-art manufacturing methods provide the best product quality and fastest delivery in the industry
- 100% assured compatibility with all equipments conforming to DIN 41494 (General industrial standard for equipments)
- Powder coated finish with seven tank pretreatment process meeting ASTM standard
- Grounding & Bonding options
- Fan module Mount Provision on top cover

Accessories:

- | | | | |
|----------------|----------------------------|--------------------|------------|
| ■ Cable Basket | ■ Power Distribution Units | ■ Fixed Shelf | ■ Plinth |
| ■ Adapter Kit | ■ Cable Organisers. | ■ Cantilever Shelf | ■ Castors |
| ■ Ganging Kit | ■ Fans and Fan Modules | ■ Sliding Shelf | ■ Levelers |
| ■ Angle Pair | ■ Rack Ground Kit | ■ Key Board Shelf | |

Model Matrix & Dimensions										
NRS 1 Series	H	h	W	w/w2	w1	D	d	d1	Caster Type	Plinth Height(MM)
22U 800X800	1079	22U	800	19"/27"	451	800	700	535	TYPE-2	50/100
22U 800X1000	1079	22U	800	19"/27"	451	1000	900	725	TYPE-2	50/100
24U 800X800	1167	24U	800	19"/27"	451	800	700	535	TYPE-2	50/100
24U 800X1000	1167	24U	800	19"/27"	451	1000	900	725	TYPE-2	50/100
27U 800X800	1300	27U	800	19"/27"	451	800	700	535	TYPE-2	50/100
27U 800X1000	1300	27U	800	19"/27"	451	1000	900	725	TYPE-2	50/100
30U 800X800	1433	30U	800	19"/27"	451	800	700	535	TYPE-2	50/100
30U 800X1000	1433	30U	800	19"/27"	451	1000	900	725	TYPE-2	50/100
32U 800X800	1522	32U	800	19"/27"	451	800	700	535	TYPE-2	50/100
32U 800X1000	1522	32U	800	19"/27"	451	1000	900	725	TYPE-2	50/100
34U 800X800	1611	34U	800	19"/27"	451	800	700	535	TYPE-2	50/100
34U 800X1000	1611	34U	800	19"/27"	451	1000	900	725	TYPE-2	50/100
36U 800X800	1700	36U	800	19"/27"	451	800	700	535	TYPE-2	50/100
36U 800X1000	1700	36U	800	19"/27"	451	1000	900	725	TYPE-2	50/100
38U 800X800	1789	38U	800	19"/27"	451	800	700	535	TYPE-2	50/100
38U 800X1000	1789	38U	800	19"/27"	451	1000	900	725	TYPE-2	50/100
40U 800X800	1878	40U	800	19"/27"	451	800	700	535	TYPE-2	50/100
40U 800X1000	1878	40U	800	19"/27"	451	1000	900	725	TYPE-3	50/100
42U 800X800	1967	42U	800	19"/27"	451	800	700	535	TYPE-2	50/100
42U 800X1000	1967	42U	800	19"/27"	451	1000	900	725	TYPE-3	50/100

Note :

1. Overall Height = Frame Height+ Plinth or Caster
2. It is recommended to distribute the Load along with U space in the Rack
3. Dimension are in MM

Description	Height (MM)	Wheel BKT (MM)	Total (MM)
TYPE-2	85	16	101
TYPE-3	105	16	121

Abbreviations

Frame Height	H
Usable Height	h
Overall width	W
Usable width	w
Usable width Between Front MTG. Angles	w1
Overall Usable Width	w2
Overall Depth	D
Usable Depth	d
Usable Depth From Front & Rear Mounting Angles	d1

